

Attachment

Confidential – Lonsdale Landfill Lease Assignment

4 pages

SECOND SCHEDULE

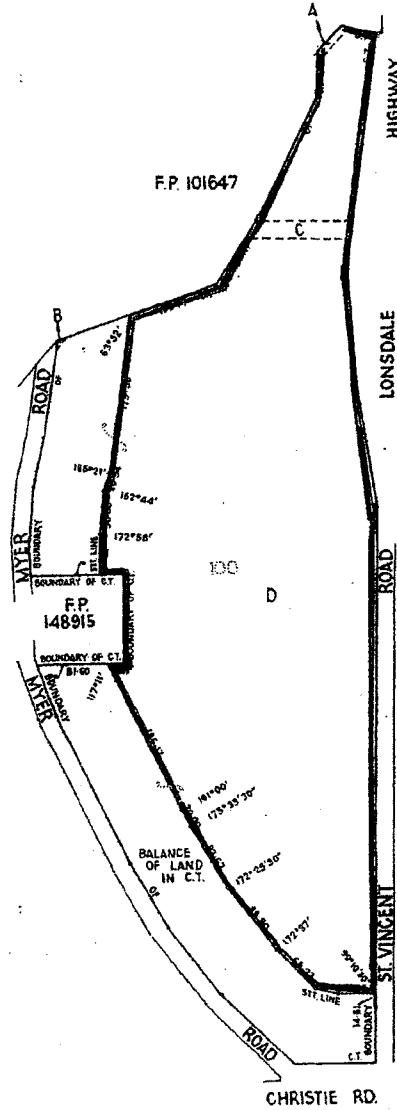

SITE & GROUND FLOOR PLAN

BLEEZE NEALE & ASSOCS. PTY. LTD.
 LICENSED SURVEYORS A.L.M. 907 U & 070
 14 / 230 MAIN SOUTH ROAD,
 MORPHETT VALE, 5162
 Telephone: (08) 8584 7344
 Fax: (08) 8226 5004 Ref: 4820-96

PLAN NUMBER			
THIS IS SHEET 1 OF 1 SHEETS			
DEPOSITED			
ACCEPTED FOR FILING 138 THE REGISTRAR GENERAL			
MAP REC. 8527-15-14 4-5-73 DEV. NO.			
TITLE SYSTEM REAL PROPERTY ACT			
TITLE REFERENCE C.T. 4244 / 614			
O.D. / LAST PLAN REF.		TOTAL AREA	
DOCKET NO.			
FIELD BOOK NO.			
CLOSURE CHECKED	PLAN EXAMINED	PLAN APPROVED	F.M.S. APPROVED
PREPARED BY			
DRAWN BY			
HUNDRED NOARLUNGA			
TOWNSHIP AREA LONSDALE			
COUNCIL CITY OF NOARLUNGA			
<p>PLAN FOR LEASE PURPOSES ALLOTMENT 100 IN D.P. 15127 OF FT. SECS. 572, 576 & 578</p>			
SCALE			
0	50	100	150 200 250 300
METRES			
STATEMENTS CONCERNING EASEMENTS ANNOTATIONS AND AMENDMENTS			
FOR THE DISPOSITION AND DATA FOR EASEMENTS A, B & C. VIDE C.T. 4244 / 614.			
ALL DISTANCES ARE GROUND DISTANCES			
COMMERCIAL ZONE			
REMARKS DISTANCE			
DERIVED FROM			
I am a registered surveyor of South Australia and I certify that this plan has been made from surveys carried out by me or under my personal supervision and is accurate and in accordance with the Survey Act 1952 / State Titles Act 1986 (being read as appropriate)			
(2) This site has been surveyed in accordance with the Survey Act 1952 / State Titles Act 1986 (being read as appropriate)			
Date			

LEGEND

NETWORK PBM	PD
NETWORK STATION	FD
PERMANENT PLACED	FD
SURVEY FOUND	FD
MARK FOUND	CONC
REFERENCE PLACED	MP OR RM
MARKS FOUND	SPR FD
	CONC
	BT CONC
DRILL HOLE & MARK	
DIRECTION CHANGE	
PAVE DISTANCES	(20 22)
CHANGING DATA	CHANGING DATA
CHANGING DATA	CHANGING DATA

CONFIDENTIAL
ATTACHMENT 1



Description of Land:

Piece 50 in Deposited Plan 47185
Certificate of Title
Volume 5890 Folio 493

Registered Proprietor
The City of Onkaparinga

Statements, Annotations and Amendments
Nil

Legend

 Lonsdale Landfill

Locality Map

 Land in question





CONFIDENTIAL

Resourceco Pty Ltd
ABN 45 068 976 803

Wingfield Road & Hines Road
Wingfield SA 5013

Postal: PO Box 542
Enfield Plaza SA 5085

Ph (08) 8347 3329
Fax (08) 8347 3556
Email info@resourceco.com.au
Web www.resourceco.com.au



2002 Telstra
Australian
Small Business of the Year



2nd July 2008

Mr Bruce Williams
General Manager - City Projects
City of Onkaparinga
PO Box 1
NOARLUNGA CENTRE SA 5168

Dear Bruce,

RE: Transfer of lease agreement from Stanvac Contracting to Resourceco

Resourceco have been operating our business at the former Cleanaway Landfill at Wingfield for over 15 years. This business has been recognised as one of Australia's premier sites for resource recovery and recycling.

While this site has been very well situated to service our customers in the North, East and Western Suburbs we were poorly positioned to service our customers in the South.

With this in mind in early 2007 we purchased the former Perpetual Products site on Myer Road at Lonsdale and the former Mitsubishi foundry off Christie Road. Resourceco see these sites as extremely well positioned to allow for similar if not improved service to the southern suburbs for inert as well as industrial waste processing.

In line with this direction Resourceco have negotiated the purchase of the whole of the land that we lease from Stanvac Contractors and take over their commitments to the final formation and Capping of the landfill that is currently owned by Onkaparinga Council and capped under a lease agreement with Stanvac Contractors.

With the above in mind Resourceco is formerly writing to you to seek approval from council to take over that lease. Resourceco are fully aware of the obligations that will come with that transfer of the lease and will work closely with Council and the EPA to ensure that the site is appropriately closed with the best outcomes for all concerned.

We will also be applying to the EPA to transfer the licence number 2861 from Stanvac Contractors to Resourceco.

CONFIDENTIAL

If you require any further information please do not hesitate to call either myself or Mike Haywood on 08 8347 3329.

Regards

A handwritten signature in black ink, appearing to be 'S. Brown', written in a cursive style.

Simon Brown
Managing Director