

## Guidelines for A and T frame Moveable Signs

*These guidelines are prepared as a reference for the placement of A and T frame moveable signs within the City of Onkaparinga. For a full outline of controls and procedures in relation to moveable signs, please refer to Section 226 of the Local Government Act 1999 and Council's By-law No 2 - Moveable Signs.*

### A and T frame signs



### Construction

An A or T frame moveable sign displayed on a public street or road shall:

1. Be of a kind known as an 'A-frame' or 'Sandwich Board' sign, an 'inverted T' sign, or a flat sign.
2. Be of strong construction so as to be stable when in position and to be able to keep its position in adverse weather conditions, with no sharp or jagged edges or corners.
3. Be maintained in good condition so as not to present a hazard to any member of the public.
4. Not contain flashing parts.
5. Be constructed of timber, metal, plastic or plastic coated cardboard, or a mixture of such materials.
6. Not exceed 900mm in perpendicular height, or have a base with any side exceeding 600mm in length.
7. Not have a display area exceeding one square metre in total or, if the sign is two-sided, one square metre on each side.
8. In the case of an A-frame or Sandwich Board sign:
  - a. be hinged or joined at the top
  - b. be of such construction that it's sides shall be securely fixed or locked in position when erected.
9. In the case of an inverted T sign, contain no struts or supports that run between the display area and the base of the sign.

### Placement

Businesses located within the Council's area are permitted by this document to place up to three moveable signs on footpath areas.

10. Signs may be placed by a business in the following locations:
  - a. One sign may be placed adjacent to the premises of the business to which the sign relates.
  - b. One sign may be placed in a location not immediately adjacent to the premises, provided that it is placed on the same street or road as the premises of the business, and no further than the intersection with that street or road with the nearest major road.
  - c. Where the nearest intersection to the street or road upon which the premises of a business is located is not an intersection with a major road, one sign may be placed at the nearest intersection between a street or road which adjoins the road upon which the premises of the business are located, and the nearest major road.

11. Moveable signs placed in any of the locations as defined in clause 1 of this section by businesses must be positioned within the footpath area of the relevant street or road.
12. Moveable signs must not be placed on a sealed part of any footpath area, unless the sealed part is wide enough to contain the sign and still leave a clear thoroughfare of sealed area of footpath of at least 1.2 metres wide.
13. Where there is no kerb to define the footpath, a set-back of 400 mm from the edge of the carriageway is required.
14. Signs must not be placed within three metres of the intersection of a street or road with another street or road.

*Please see next page for graphical placement guidelines for A and T frames.*

## Restrictions

The signs shall:

1. Only display material which advertises the business or the products available from the business to which the sign relates being conducted on commercial premises.
2. Not be in a position that places the safety of any user of the street or road at risk.
3. Not be displayed during the hours of darkness unless it is clearly visible.
4. Not be displayed on a median strip, traffic island or on a carriage way of a street or road.
5. Only be displayed when the business is open.
6. Not hinder pedestrian access along the street verge.
7. Not be placed at any point that is considered, in the opinion of a Council officer, to be a hazard.

Please note that it is the responsibility of the owner of the sign to ensure that the placement of signs is in accordance with the guidelines.

## Unauthorised Signs

Movable signs displayed contrary to these guidelines will be requested to be removed. Expiation and removal fees may apply to signs that do not comply with these guidelines.

Expiation Fee - \$100.00 per sign

Removal Fee - \$46.50 per sign

For clarification or further information please contact our Development Compliance section on 8384 0666.

**NB: All other types and placement requirements will require a **permit** from the City of Onkaparinga (excluding approved 'vertical banner' style signs – click [here](#) for Guidelines)**

# Guidelines for the Placement of Moveable Signs

## - Illustration representing available options -

- Business A - one sign in front of the premises, and one further sign placed along the road at the intersection with the first major road
- Business B - One sign in front of the premises, a second sign at the intersection with the first feeder road from a major road, and a third sign at the intersection of that feeder road with the major road.
- Business C - One sign in front of the premises only.

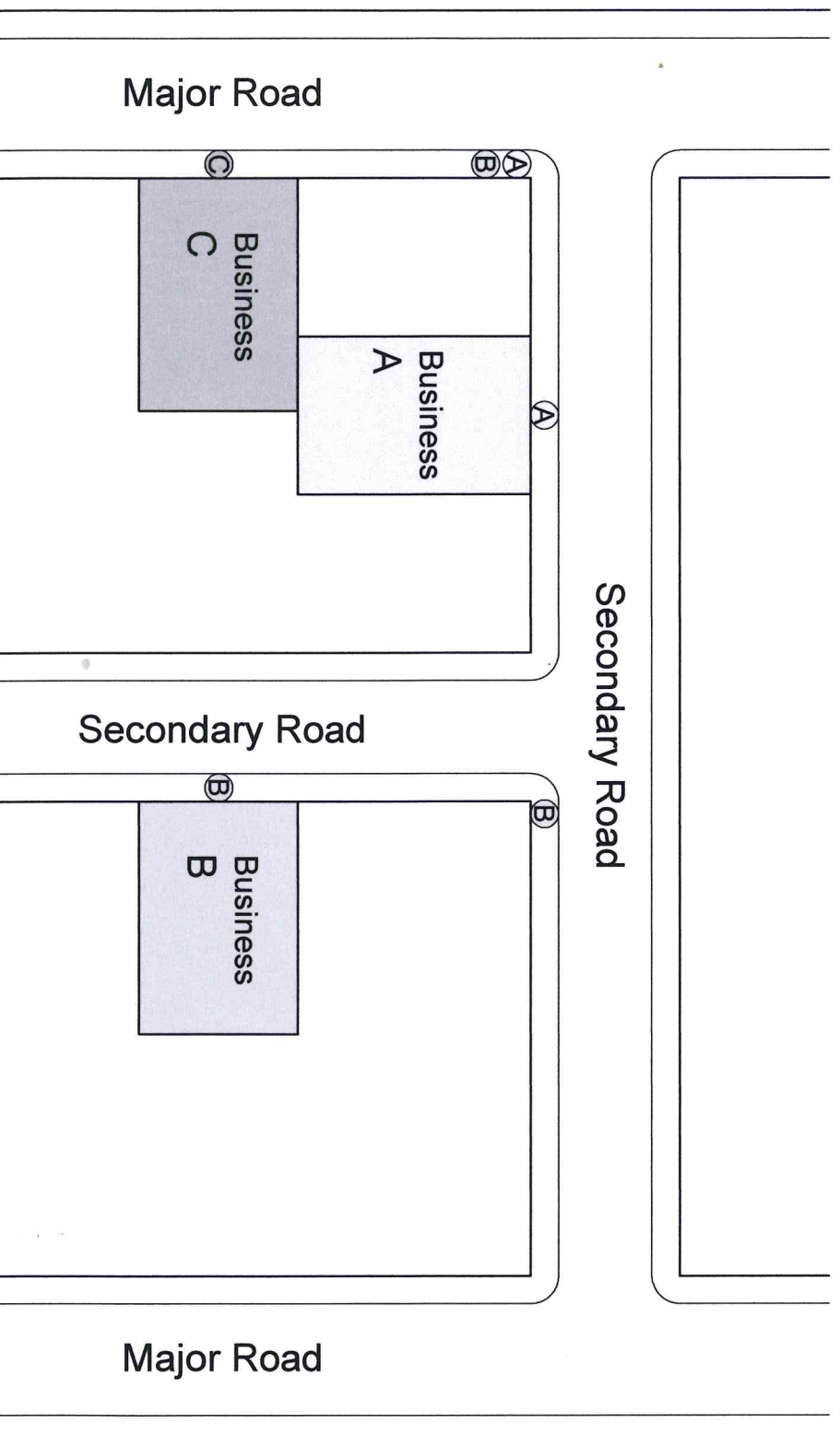

intentionally left blank

## Guidelines for Vertical Banner Moveable Signs

*These guidelines are prepared as a reference for the placement of moveable signs within the City of Onkaparinga. For a full outline of controls and procedures in relation to moveable signs, please refer to Section 226 of the Local Government Act 1999 and Council's By-law No 2 - Moveable Signs.*

### Vertical Banner Signs - Encompassing Feather, Teardrop, Blade Wing types

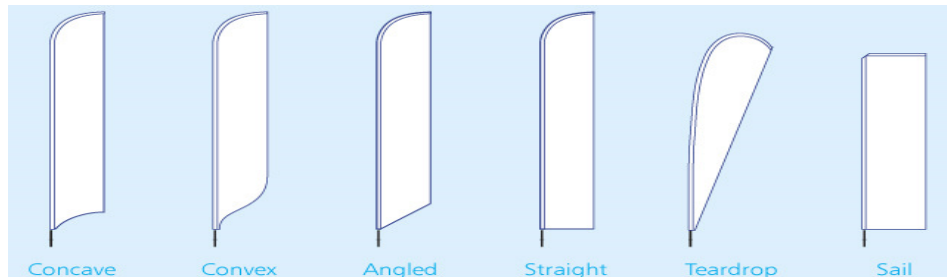

### Construction

A vertical banner sign displayed on a public street or road shall:

1. Be of a kind known as a 'feather', 'teardrop' or 'blade wing' sign.
2. Be of strong construction so as to be stable when in position and to be able to keep its position in adverse weather conditions, with no sharp or jagged edges or corners.
3. Be maintained in good condition so as not to present a hazard to any member of the public.
4. Not contain flashing parts.
5. Be a fabric sign with single mast
6. Have a solid or filled base 10-25kg
7. Banner mast must be constructed of carbon fibre or similar flexible material, which is to be attached to a weighted base, so that the can be displayed without toppling over.
8. On an open verge - maximum flag size of 2.76m x 1m with a total height including stand of 3.5m.
9. On a footpath - maximum flag size of 2m x 1m with a total height including stand of 2.5m.
10. No more than 60cm wide below 2m high.

### Placement

Businesses located within the Council's area are permitted by this document to place vertical banners on footpath areas. The banners must be:

11. Placed so as not to contact any structure tree or object
12. No more than one vertical banner per 4 metres of frontage, and excludes the use of an A frame or T frame sign
13. To be placed only on the immediate street frontage of the business
14. Moveable signs placed in any of the locations as defined in clause 1 of this section by businesses must be positioned within the footpath area of the relevant street or road
15. Moveable signs must not be placed on a sealed part of any footpath area, unless the sealed part is wide enough to contain the sign and still leave a clear thoroughfare of sealed area of footpath of at least 1.2 metres wide
16. Where there is no kerb to define the footpath, a set-back of 400 mm from the edge of the carriageway is required
17. Signs must not be placed within three metres of the intersection of a street or road with another street or road.

## Bases

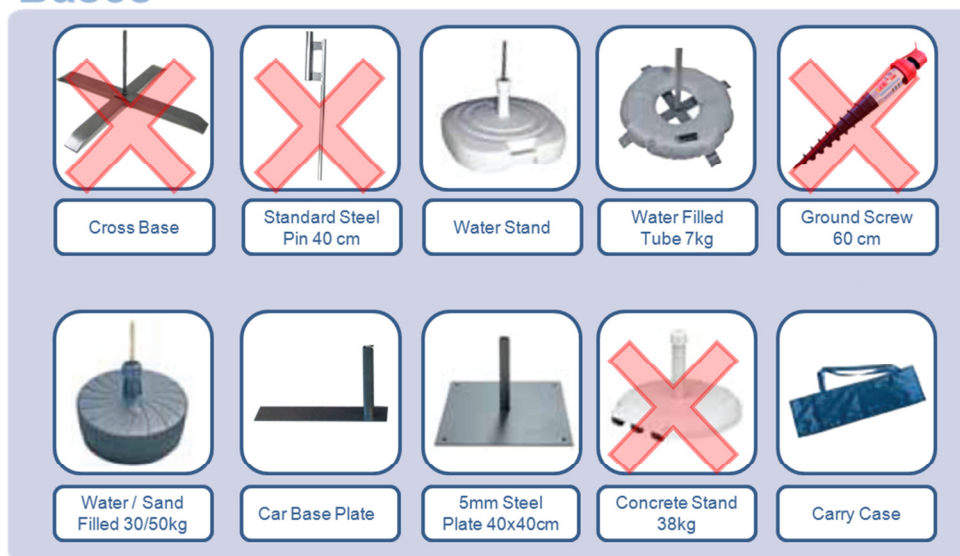

 Permit required for this device

## Restrictions

The signs shall:

1. Only display material which advertises the business or the products available from the business to which the sign relates being conducted on commercial premises.
2. Not be in a position that places the safety of any user of the street or road at risk.
3. Not be displayed during the hours of darkness unless it is clearly visible.
4. Not be displayed on a median strip, traffic island or on a carriage way of a street or road.
5. Only be displayed when the business is open.
6. Not hinder pedestrian access along the street verge.
7. Not be placed at any point that is considered, in the opinion of a Council officer, to be a hazard.

Please note that it is the responsibility of the owner of the sign to ensure that the placement of signs is in accordance with the guidelines.

## Unauthorised Signs

Movable signs displayed contrary to these guidelines will be requested to be removed. Expiation and removal fees may apply to signs that do not comply with these guidelines.

Expiation Fee - \$105.00 per sign

Removal Fee - \$55.20 per sign

For clarification or further information please contact our Development Compliance section on 8384 0666.

**NB: All other types and placement requirements will require a permit from the City of Onkaparinga (excluding A and T frame signs – click [here](#) for Guidelines)**